



Solenoid Valve Connectors

Form B to MDC (M12) Solenoid Valve Receptacles



Form B to Micro-DC (M12) Male Receptacle | Industry Standard | IP65 Rating

# of Poles	Voltage	Circuitry	Housing Color	M12 (MDC) # of Poles	
				4 Pole	5 Pole
2 + Ground	250V AC/DC (Maximum)	None	Gray	VJN-029-3401	VJN-029-3501
			Black	VDN-029-3401	VDN-029-3501
	10-50V DC	LED w/ Flyback Diode	Clear	VDC-029-3401	VDC-029-3501
	24V AC/DC	LED w/ MOV	Clear	VDG-029-3401	VDG-029-3501
	120V AC/DC	LED w/ MOV	Clear	VDJ-029-3401	VDJ-029-3501

Two standard orientations are available. Please refer to the part number system shown above each drawing.

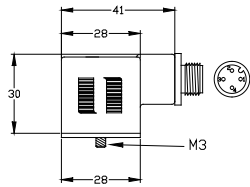

Vxx-029-3401

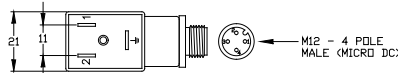

2 Poles + Ground
(Ground Receptacle Side)

Vxx-029-3501

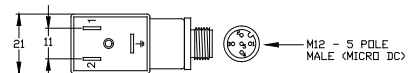

2 Poles + Ground
(Ground Receptacle Side)

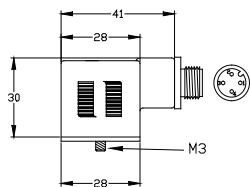

Vxx-089-3401

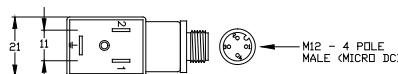

2 Poles + Ground
(Ground Opposite Receptacle Side)

Vxx-089-3501

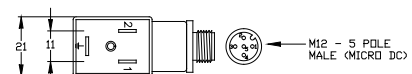

2 Poles + Ground
(Ground Opposite Receptacle Side)

DIN Connector Specifications:

- Body: Polyamide
- Contacts: Copper Alloy with Silver Plating
- Insert: Polyamide
- Gasket: Thermoplastic
- Screw: Zinc Plated Steel
- Temperature: -25°C to 90°C (-13°F to 194°F)

MDC Connector Specifications:

- Body: Oil Resistant Black PVC
- Coupling Nut: Nickel Plated Brass
- Insulator: Polyamide
- Contacts: Copper Alloy with Gold Plating
- O-Ring: BUNA-N
- Temperature: -40°C to 80°C (-40°F to +176°F)

Valve Connectors	M12 (MDC) 4 Pole PIN #	M12 (MDC) 5 Pole PIN #
1	4	4
2	3	3
Ground	Not Used	5
	1, 2 & 5 Not Used	1 & 2 Not Used

Valve Connectors

